

- Grease
- Threadlocker
- Grease + Threadlocker

Apply grease to the shaft, and locker to the threads

| ITEM No. | DESCRIPTION                  | QTY. | PART NUMBER | TORQUE |
|----------|------------------------------|------|-------------|--------|
| 1        | FRAME                        | 1    |             |        |
| 2        | HANGER                       | 1    | SET1        |        |
| 3        | HANGER NUT                   | 1    | 099.16011   | 4Nm    |
| 4        | DISC ADAPTOR                 | 1    | SET3        |        |
| 5        | CABLE GUIDE                  | 1    | SET2        |        |
| 6        | SCREW BOLT M3x10             | 1    | SET2        | 3Nm    |
| 7        | WASHER                       | 2    |             |        |
| 8        | WASHER                       | 2    |             |        |
| 9        | SCREW BOLT M5x35             | 2    | SET3        |        |
| 10       | WASHER                       | 2    | SET3        |        |
| 11       | REAR AXLE, 12X148 P1.75 L180 | 1    | 112.90022   |        |
| 12       | SEAT CLAMP 31.8MM            | 1    | 099.21030   |        |
| 13       | CHAINSTAY PROTECTOR          | 1    | 099.21000   |        |

| PART NUMBER | DESCRIPTION               | COMPONENTS  |
|-------------|---------------------------|---|
| 099.00055   | SET 1: HANGER M068        | HANGER M068 (x1) / HANGER NUT (x1)                      |
| 099.19010   | SET 2: CABLE GUIDE KIT 3  | CABLE GUIDE (x1) / SCREW BOLT (x1)                      |
| 099.19005   | SET 3: DISC ADAPTOR KIT 2 | DISC ADAPTOR KIT 2 (x1) / SCREW BOLT (x2) / WASHER (x2) |

**SET 1**  
HANGER M068

**SET 2**  
CABLE GUIDE KIT 3

**SET 3**  
DISC ADAPTOR KIT 2

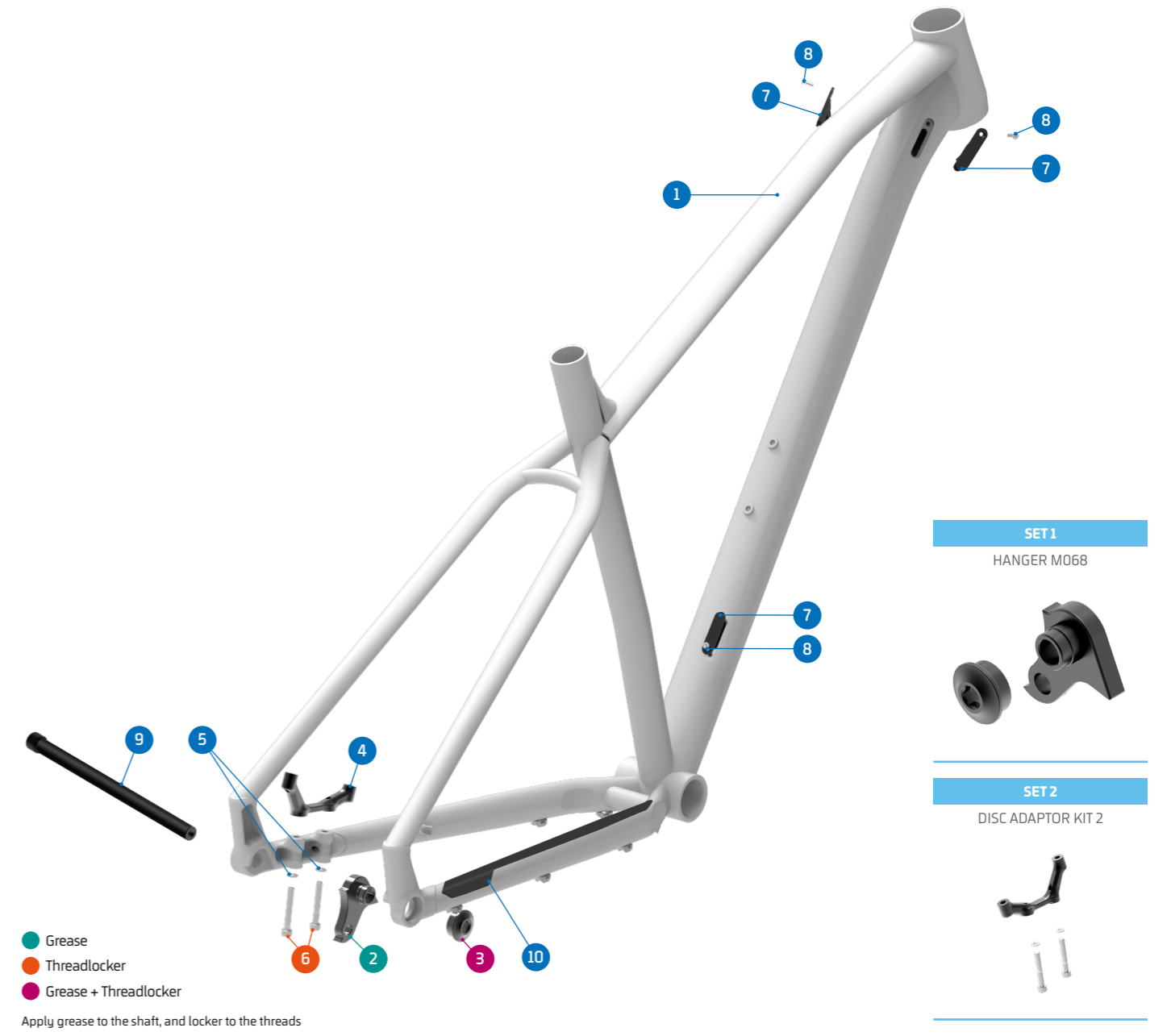

- Grease
- Threadlocker
- Grease + Threadlocker

Apply grease to the shaft, and locker to the threads

| ITEM No. | DESCRIPTION                  | QTY. | PART NUMBER | TORQUE |
|----------|------------------------------|------|-------------|--------|
| 1        | FRAME                        | 1    |             |        |
| 2        | HANGER                       | 1    | SET1        |        |
| 3        | HANGER NUT                   | 1    | 099.16011   | 4Nm    |
| 4        | DISC ADAPTOR                 | 1    | SET2        |        |
| 5        | SPACER                       | 2    | SET2        |        |
| 6        | SCREW BOLT M5x35             | 2    | SET2        | 8Nm    |
| 7        | CABLE GUIDE                  | 5    | SET3        |        |
| 8        | SCREW BOLT M3x10             | 5    | SET3        |        |
| 9        | REAR AXLE, 12X148 P1.75 L180 | 1    | 112.90022   |        |
| 10       | CHAINSTAY PROTECTOR          | 1    | 099.21003   |        |

| PART NUMBER | DESCRIPTION               | COMPONENTS  |
|-------------|---------------------------|---|
| 099.00055   | SET 1: HANGER M068        | HANGER M068 (x1) / HANGER NUT (x1)                      |
| 099.19005   | SET 2: DISC ADAPTOR KIT 2 | DISC ADAPTOR KIT 2 (x1) / SCREW BOLT (x2) / WASHER (x2) |
| 099.19010   | SET 3: CABLE GUIDE KIT 3  | CABLE GUIDE (x1) / SCREW BOLT (x1)                      |

**SET 1**  
HANGER M068

**SET 2**  
DISC ADAPTOR KIT 2

**SET 3**  
CABLE GUIDE KIT 3